

Using the Laminator

Step 1: Plug the laminator in

- Insert the plug into an outlet.



Step 2: Turn the laminator on

- On the side of the laminator, push the power switch to the "Hot" position.



Step 3: Insert the item into the laminating pouch

- One edge of the pouch is sealed. Open the pouch and place the item in it, aligning the top of the item with the sealed edge, and making sure the left and right borders are equal.

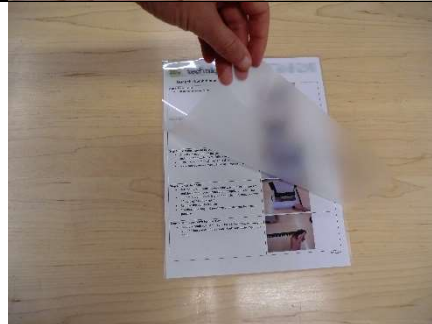

Step 4: Wait for the laminator to be ready

- When the laminator is at temperature, the green "Ready" light will illuminate.



Step 5: Insert the item into the laminator

- Leading with the sealed edge of the pouch, insert the item straight into the machine.
- Try to roughly center the item to the opening in the machine.
- The motor will grab and begin moving the item through the laminator.



Step 6: Remove the finished item

- The laminated item will exit from the back of the machine.
- Once the item has stopped moving, remove it promptly from the back of the machine.



Step 7: Turn off and unplug the laminator

- Push the power switch to the "Off" position.
- Unplug the machine.

