

Sewing Machine – Threading a Bobbin

Step 1: Remove the cover plate

- Slide the black latch to the right to release the cover plate.
- Set the cover plate aside.



Step 2: Insert the bobbin

- The bobbin can be inserted with either side facing up, but it is easier if the thread is coming off the left side of the bobbin when it is inserted.
- Place the bobbin in the bobbin holder.



Step 3: Thread the tensioner

- Guide the thread into the notch (indicated with an arrow in the picture) at the front of the bobbin holder.
- Place a finger on the bobbin to stop it spinning.
- Pull the thread to the left until it clicks into place in the thread tensioner.

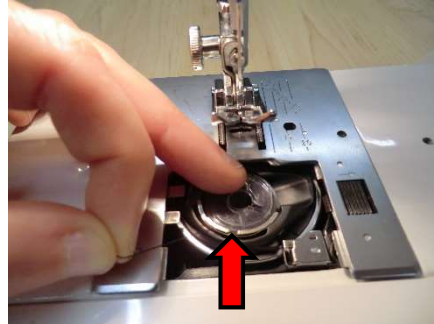

Step 4: Pull the thread through the feed dogs

- Hold the needle thread in one hand.
- Turn the balance wheel through one complete cycle, stopping when the take-up lever is at its highest position.
- This will bring a loop of bobbin thread up through the feed dogs and the presser foot.
- Pull gently until the end of the bobbin thread comes up as well.



Step 5: Replace the cover plate

- Reinsert the clear cover plate by sliding the left edge in first and then pressing gently on the right edge until it locks into place.

